

MASS MoCA

MAP



WELCOME

BUILDING 4

- 3 *Kissing through a Curtain*
- 2 *Kissing through a Curtain*
Joseph Beuys
- 1 Blane De St. Croix
Ad Minoliti
(on view through March 28)
Close to You
(on view beginning April)

BUILDING 5

- Ledelle Moe
(on view through Jan. 24)
- Glenn Kaino
(on view beginning March)

BUILDING 6

- 3 Laurie Anderson
Jenny Holzer
*"How does your
horn sound?"*
Shaun Leonardo
(on view through Dec. 20)
Richard Nielsen
Gunnar Schonbeck
- 2 Louise Bourgeois
Sarah Crowner
ERRE
Mary Lum
Metabolic Studio
Sarah Oppenheimer
Barbara Prey
Ben Ripley
(on view through Jan. 17)
Jarvis Rockwell
James Turrell
Joe Wardwell
The Prow

- 1 Mary Lum
James Turrell
Nicholas Whitman

BUILDING 7

Sol LeWitt

BUILDING 8

Spencer Finch

BUILDING 10

- 3 **Club B10**
- 2 **Kidspace**
Wendy Red Star
- 1 **Lobby**
Box Office
Museum Store
Security
Café

- LL Restrooms**
Coatroom
Allovers

BUILDING 11

- 2 Tom Slaughter
- 1 **The Hunter Center for
the Performing Arts**
Gamaliel Rodriguez

DID YOU KNOW?

Much of the work we show in our galleries and on our stages is made right here during extensive artist-in-residence programs that bring some of the world's most brilliant and innovative artists to North Adams year-round.

➔ **ONE WAY**

⋯⋯ **TO JAMES TURRELL**

⋯⋯ **TO KIDSPACE**

⬆️⬆️ **ELEVATOR**

📊 **STAIRS**

♿️ **RESTROOM**

🎫 **BOX OFFICE**

🛍️ **MUSEUM STORE**

👕 **COATROOM**

🏥 **NURSING STATION**

🍴 **CAFÉ**

Ⓧ **COURTYARD**

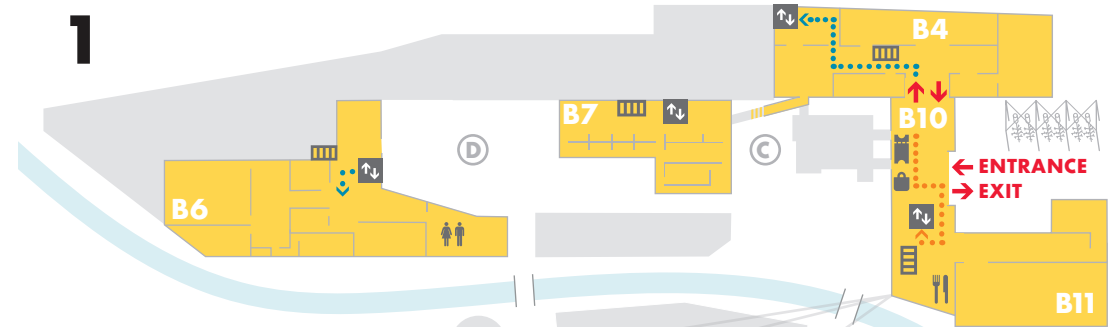
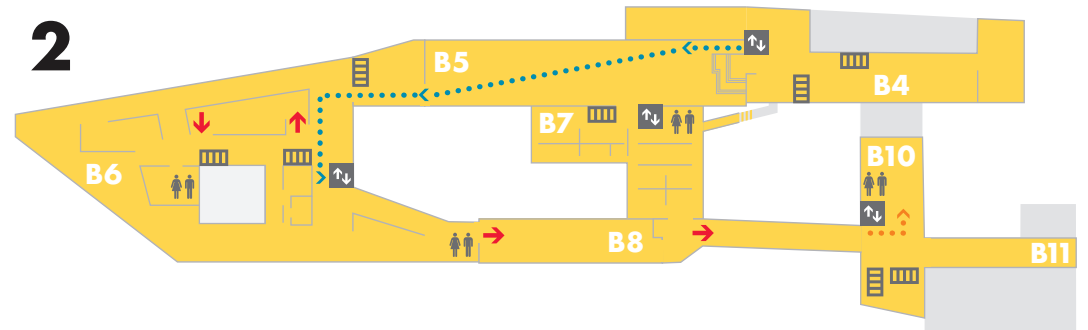

VISITING

Art

To help protect delicate art, umbrellas, folding chairs, bags, and backpacks over 8.5"×11"×4", and other large objects are not allowed in the galleries.

And please, don't touch!

Reservations

Reservations for Wendy Red Star in Kidspace and James Turrell can be made online. Space is limited.

Accessibility

Ask about wheelchairs and gallery stools at the Box Office located in the museum lobby. A nursing room is located on the 3rd floor of B10.

accessibility@massmoca.org

massmoca.org

MUSEUM HOURS

Thursdays–Mondays, 10am–5pm

Closed Tuesdays & Wednesdays

Closed Thanksgiving and Christmas Day

Over 65 and Immunocompromised Admission

Thursdays & Sundays, 10–11am

Waiver of Liability Associated with COVID-19

In purchasing an admission ticket to MASS MoCA, you acknowledge that visiting MASS MoCA's facilities, galleries, grounds, and common areas carries with it the inherent risk of contracting COVID-19, which is a dangerous and possibly fatal contagious disease.

By entering MASS MoCA's facilities and grounds, you and your family and estate covenant not to sue the City of North Adams, the MASS MoCA Commission, the MASS MoCA Foundation, their boards, staff, officers, commercial tenants, exhibiting artists, vendors, and independent contractors, and you release those parties from any and all liability, claims, damages, medical expenses, or long-term care costs that may be sustained by you related to COVID-19 contracted while on MASS MoCA property.

In order to keep our staff and patrons safe, we reserve the right to ask you to leave if you become ill during your visit.



#massmoca
@massmoca